



HAIS

Airwatch Enrollment – Android Devices

Helpdesk and Desktop Support Guide

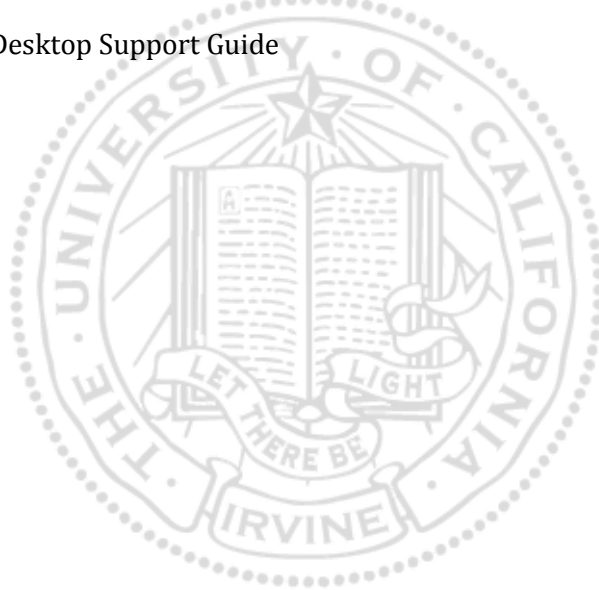

Table of Contents

Airwatch Enrollment – Android Devices	3
Connecting to the Wireless Network.....	3
Enrolling your Android Device in Airwatch	4
Appendix	25



Airwatch Enrollment – Android Devices

Here we will cover how to connect to a wireless network along with how to enroll your Android device in Airwatch.

Connecting to the Wireless Network

1. Navigate to Settings
2. On the main settings page, Tap on '**Wi-Fi**'

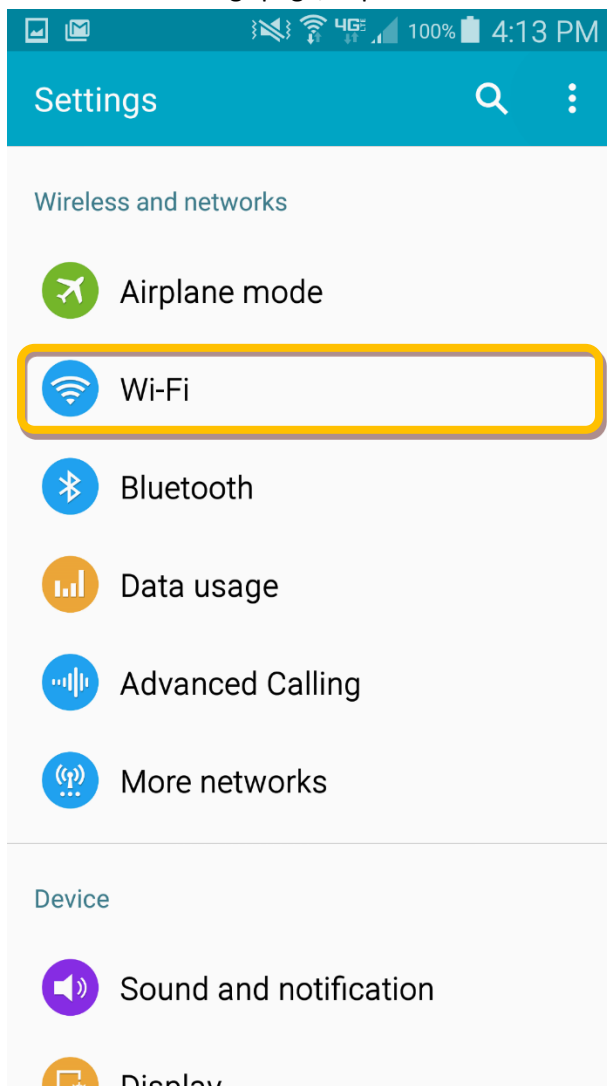

3. A list of available wireless networks will appear. Tap on 'UCIHealth'

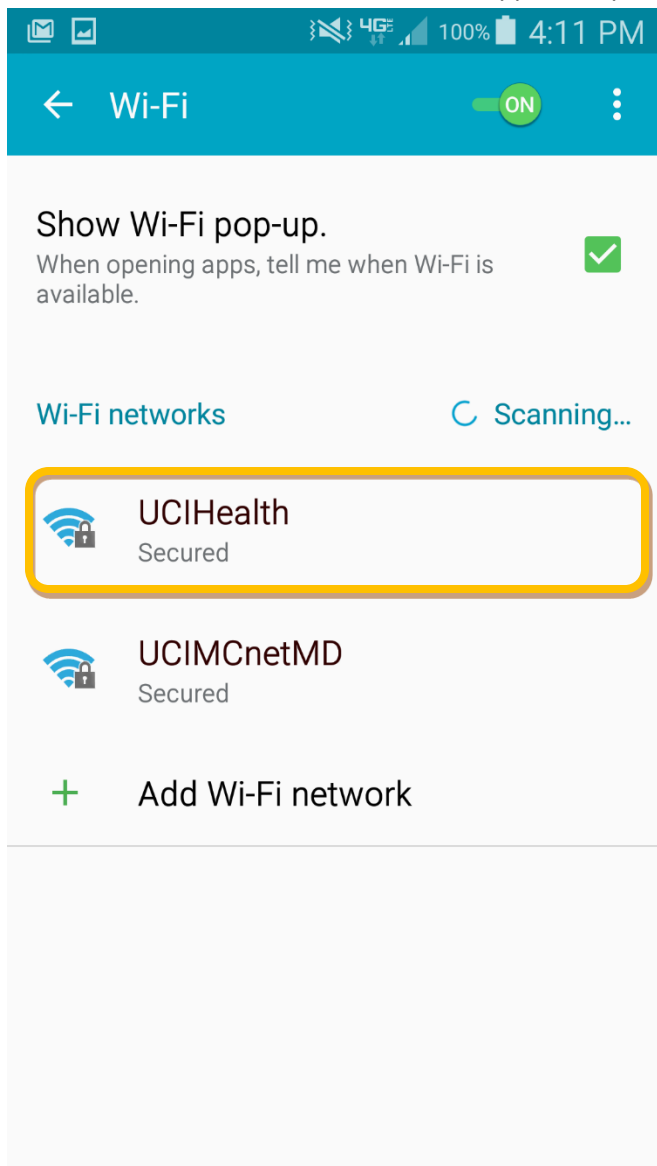

4. Enter the password: **ucirvineaccess** and tap 'Connect'

Enrolling your Android Device in Airwatch

1. Open your Web browser.

2. Your browser will be redirected to a landing page. Tap on 'Agree'.

UC IRVINE HEALTH NETWORK ACCESS

Wireless Network Acceptable Use Policy

Access to the wireless network is for the use of authorized personnel only. UC Irvine Health does not warrant the security, performance, reliability or availability of the wireless network, nor its suitability for any purpose.

All devices connected to UC Irvine Health networks are subject to monitoring for all lawful purposes, including to ensure authorized use, for management of the device and to facilitate protection against unauthorized access. During monitoring, information may be examined, recorded, copied and used for authorized purposes. Evidence of unauthorized use collected during monitoring may be used for criminal prosecution by University staff, legal counsel and law enforcement agencies.

Use of UC Irvine Health network by any computing device, authorized or unauthorized, constitutes consent to this policy and the policies and procedures set forth by UC Irvine Health.

- You will use the UC Irvine Health Wireless services in an ethical and lawful manner.
- You will not engage in activities that may degrade network performance, nor attempt to compromise network or machine security.
- You will not expose UC Irvine Health to any unnecessary risks such as introducing malicious virus activities or downloading piracy software.
- You will not infringe on copyright laws or software licenses.
- UC Irvine Health reserves the right to terminate your connection at any time.

3. Tap on 'Individuals who have a permanent account'

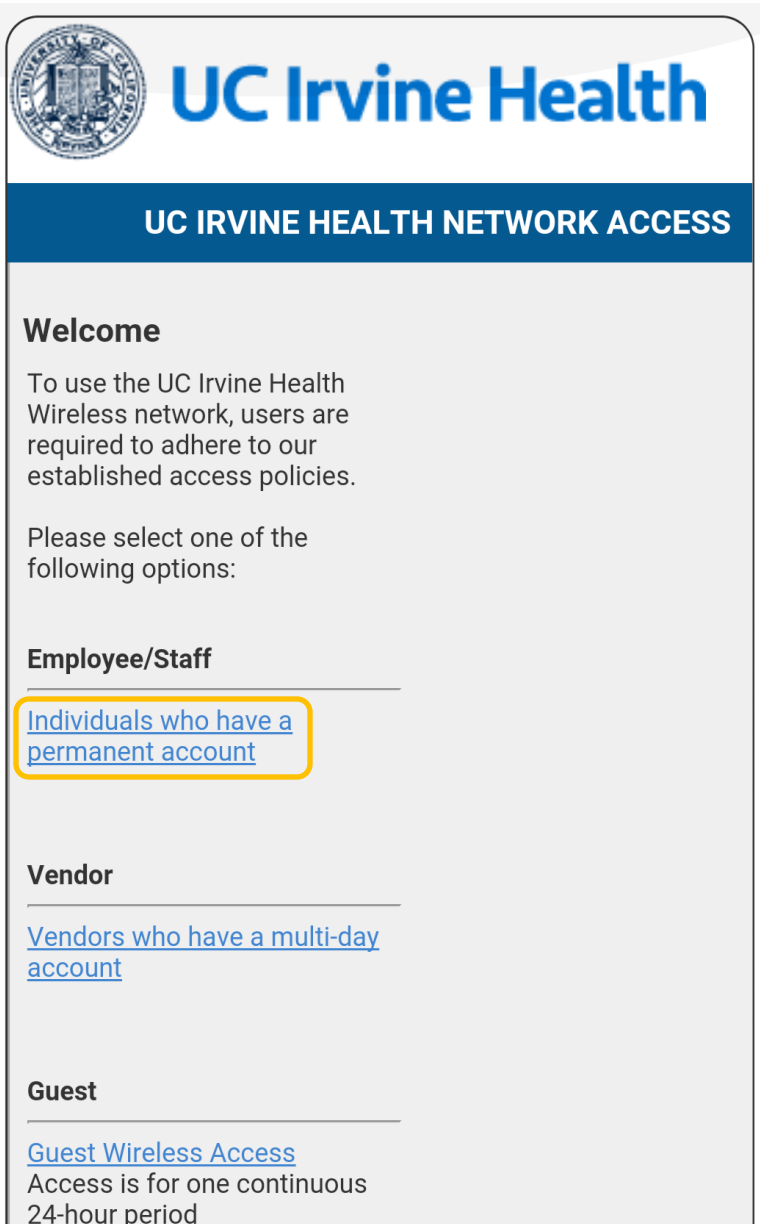

 **UC Irvine Health**

UC IRVINE HEALTH NETWORK ACCESS

Welcome

To use the UC Irvine Health Wireless network, users are required to adhere to our established access policies.

Please select one of the following options:

Employee/Staff

[Individuals who have a permanent account](#)

Vendor

[Vendors who have a multi-day account](#)

Guest

[Guest Wireless Access](#)

Access is for one continuous 24-hour period

4. Enter in your UCIHS Username and Password. Tap on 'Agree'.

You must already have an active account in order to register.

- If you know your User Name and Password, please fill out the form below and click the Agree button.
- If you do not know your User Name and password, please contact the Help Desk.

When you have filled out the form, you will be prompted to download and run the Client Security Agent to verify that your device will meet these policies. The process will take approximately one to two minutes. Do not interrupt this process while it is running.

Please enter your User Name and Password. Then click the Agree button to download and run the Client Security Agent.

 [Instructions](#)

User Name

Password

5. Next you will have to install the **Airwatch MDM Agent** from the Google Play Store. Tap on 'Download AirWatch MDM Agent from the Google Play Store'. If you already have the AirWatch MDM Agent installed, Tap on 'Already Installed? Tap here to continue enrollment'.

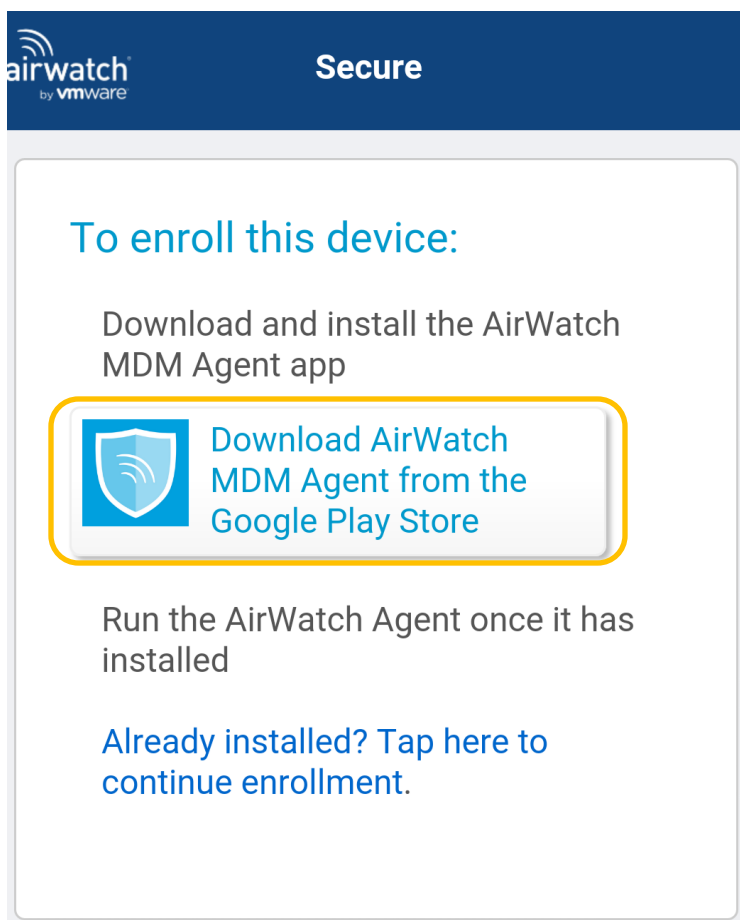

6. You may be prompted to select what to **Open with**, if so Tap on '**Play Store**' & Tap on '**Always**'

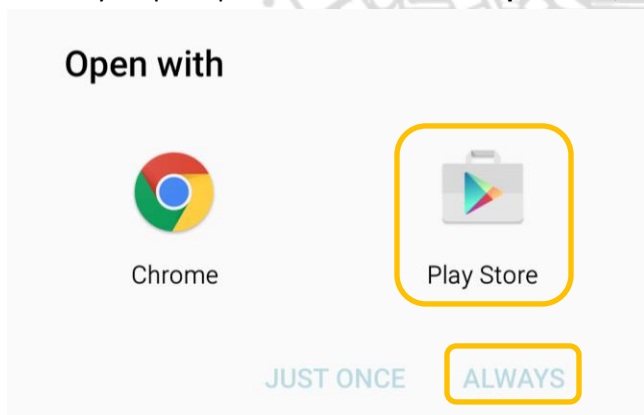

7. You will be redirected to the Google Play Store to Install the AirWatch Agent. Tap on 'Install'



8. Next you will be prompted with what AirWatch Agent needs access to. Tap on **'Accept'**

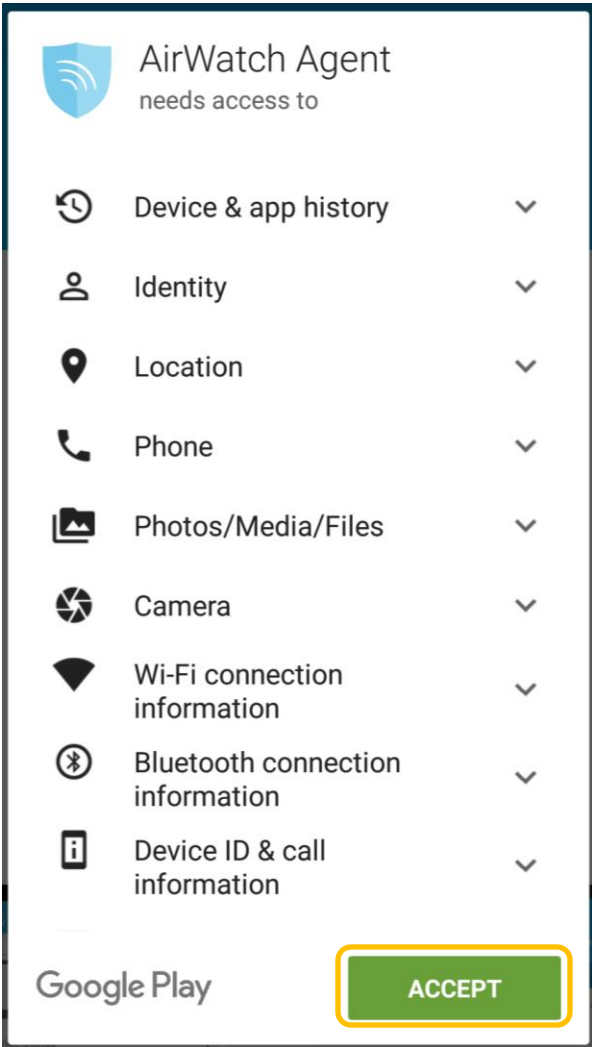

9. Once the AirWatch Agent has been installed, you'll want to go back your Web Browser. Tap on **'Already Installed? Tap here to continue enrollment.'**

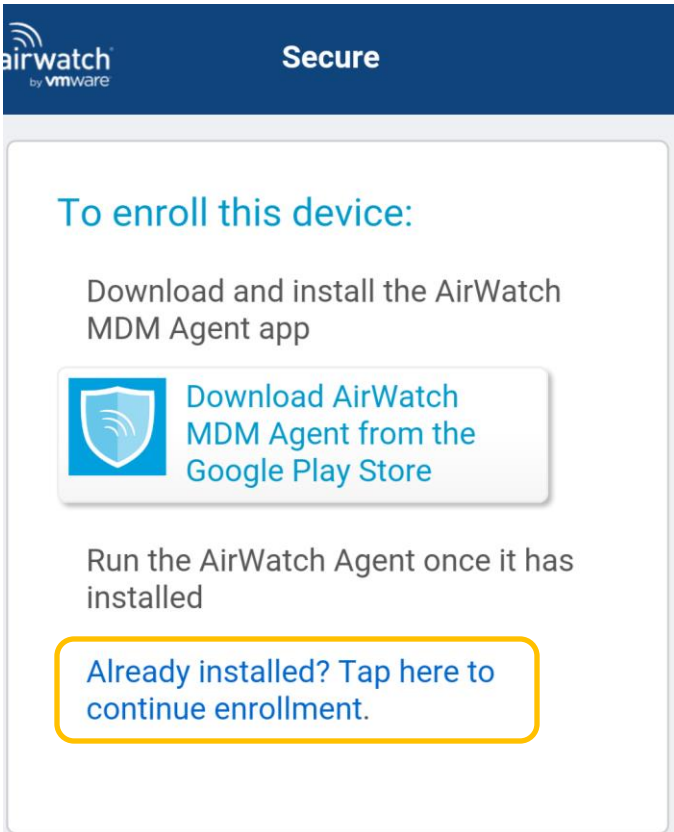

10. Enrollment will begin. Your Credentials that you entered in earlier will be automatically carried over to the enrollment process. Tap on **'Get Started'** to continue the enrollment process.

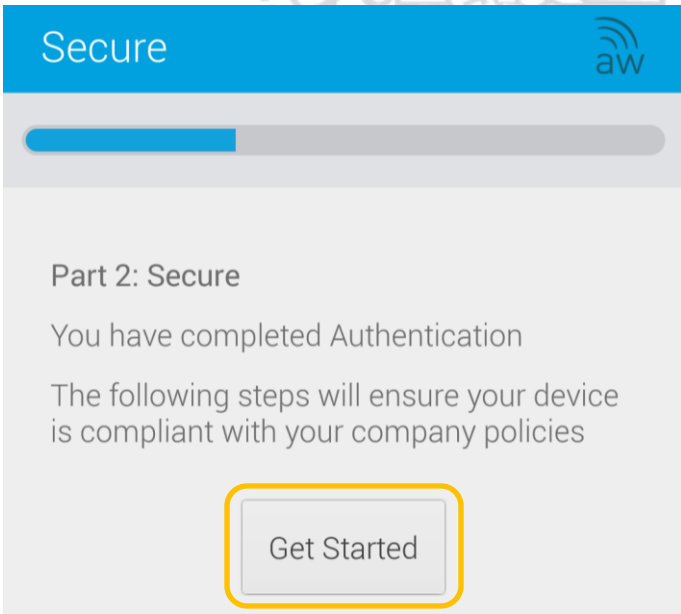

11. Next we will have to grant permission to AirWatch. Tap on '**Continue**'

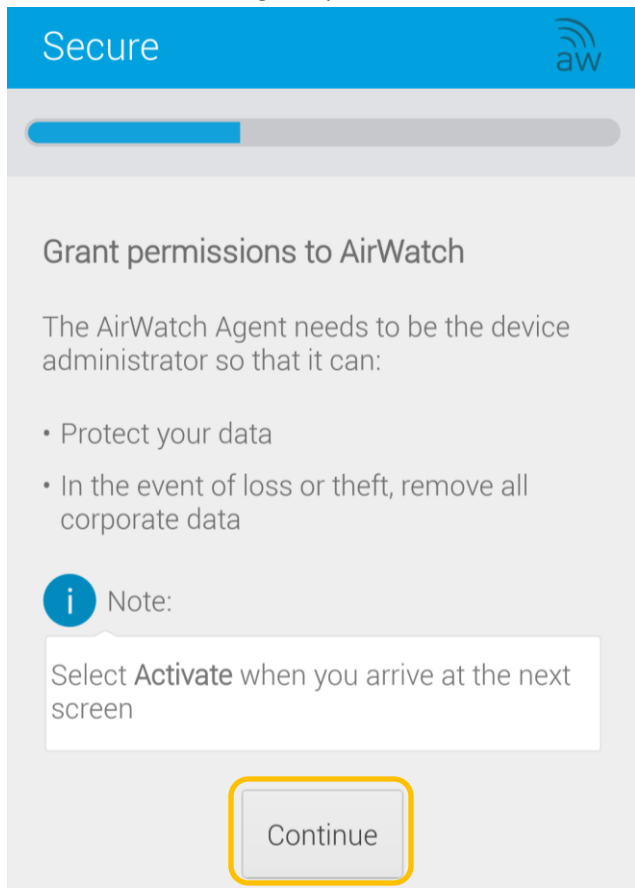

12. Tap on 'Activate'.

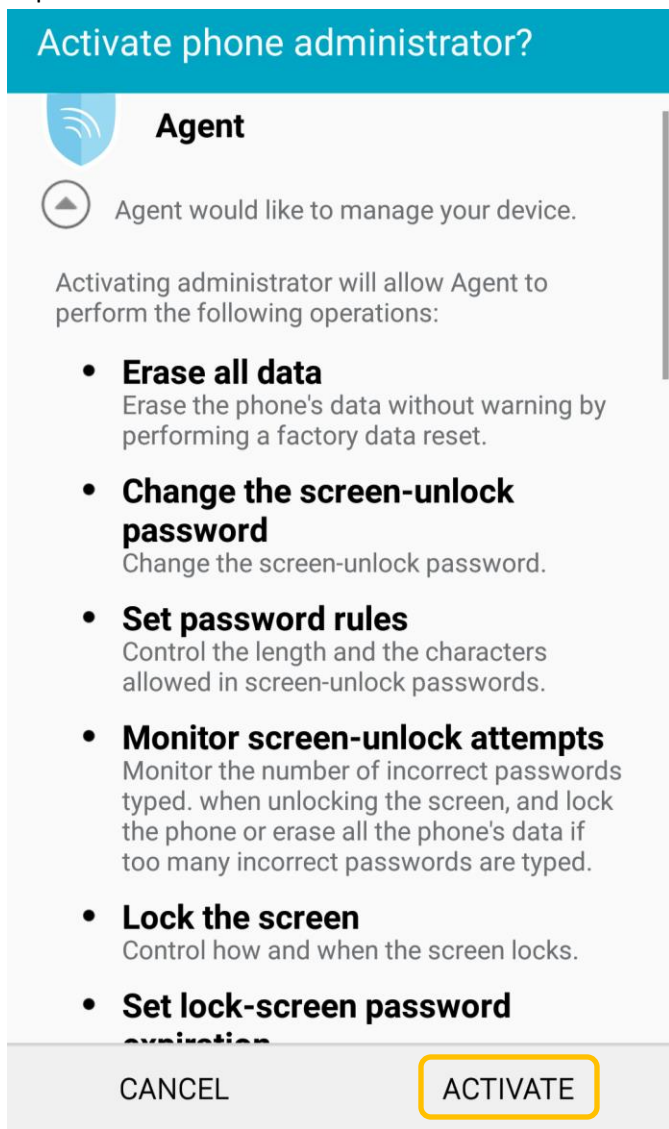

13. Tap on '**Device Settings**'. This will allow UCI Apps to be used on your Android Device.

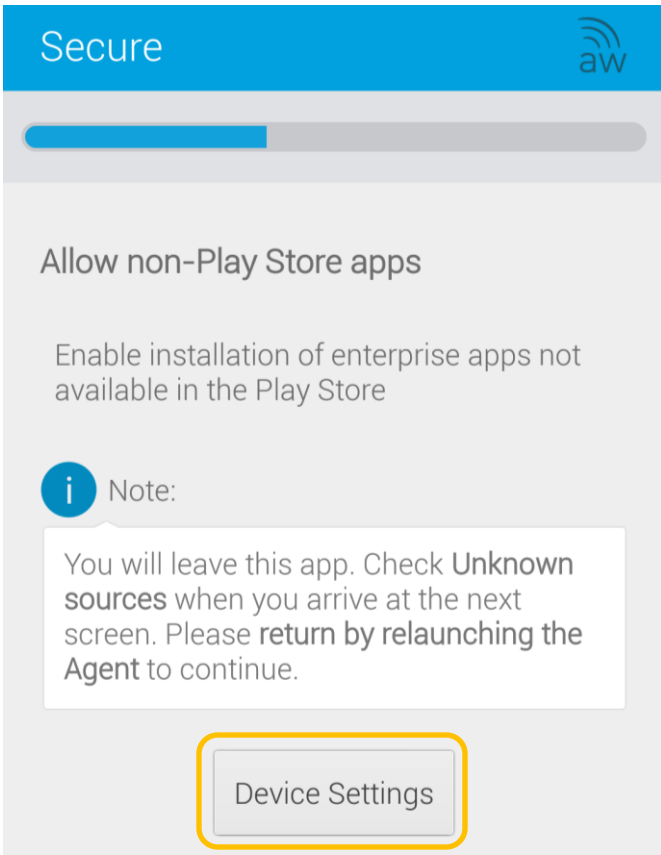

14. Tap on the box to the right of **Unknown Sources**. Once the Box is check, it will fill Green.

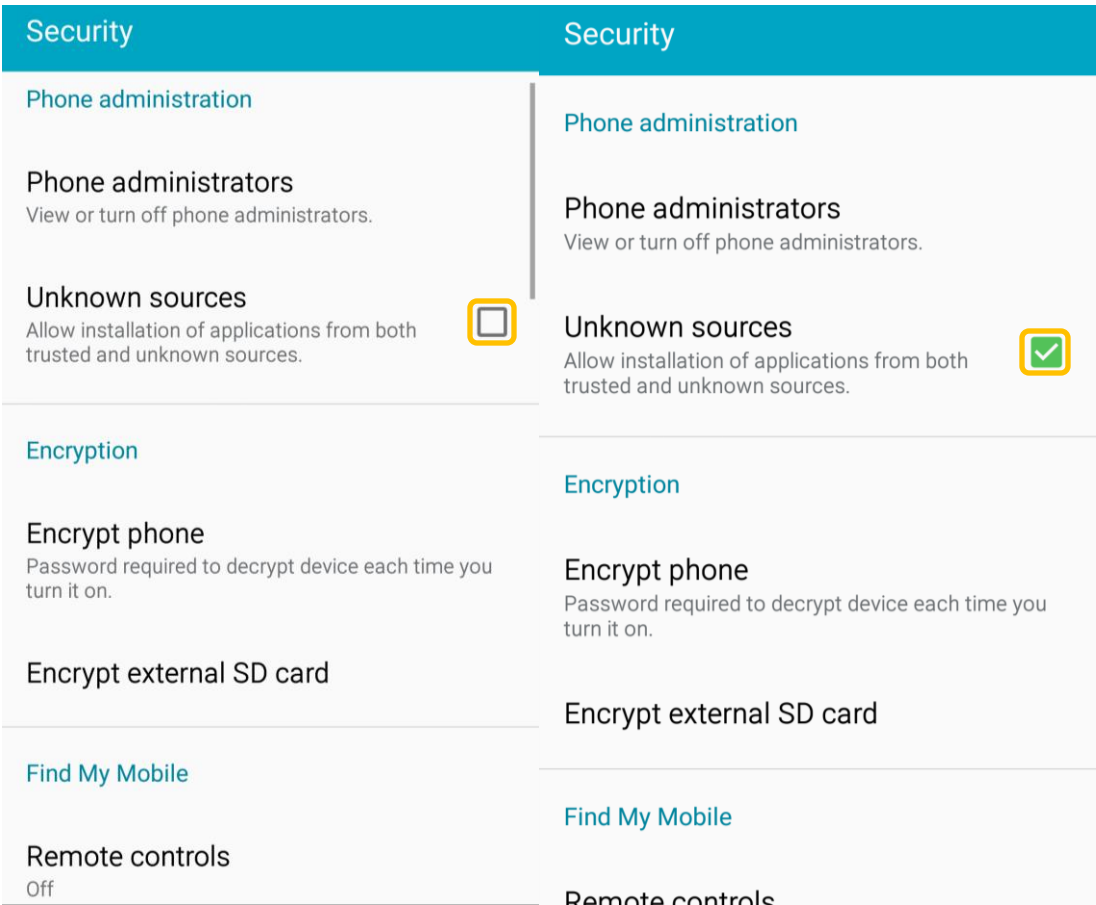

15. Tap on '**Continue**'.

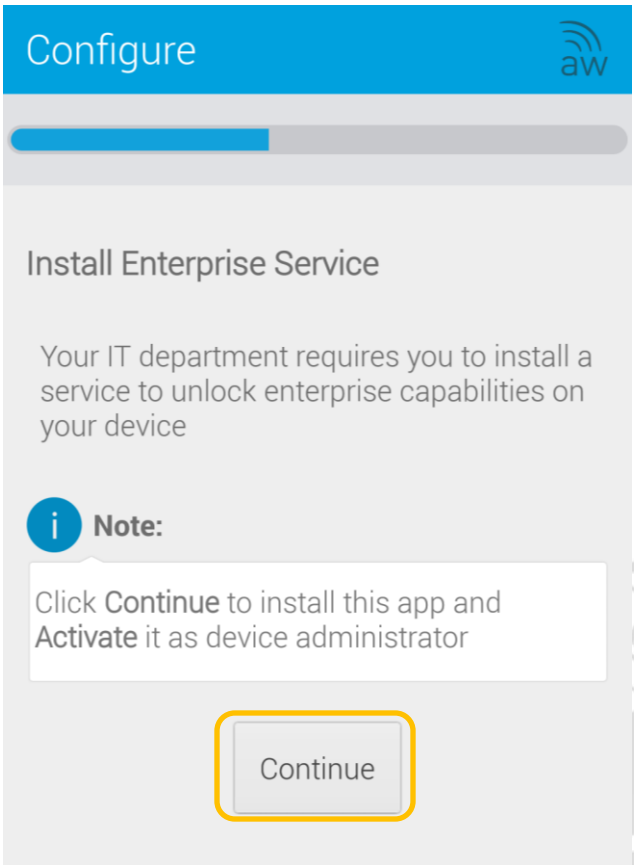

16. Tap on 'Next'

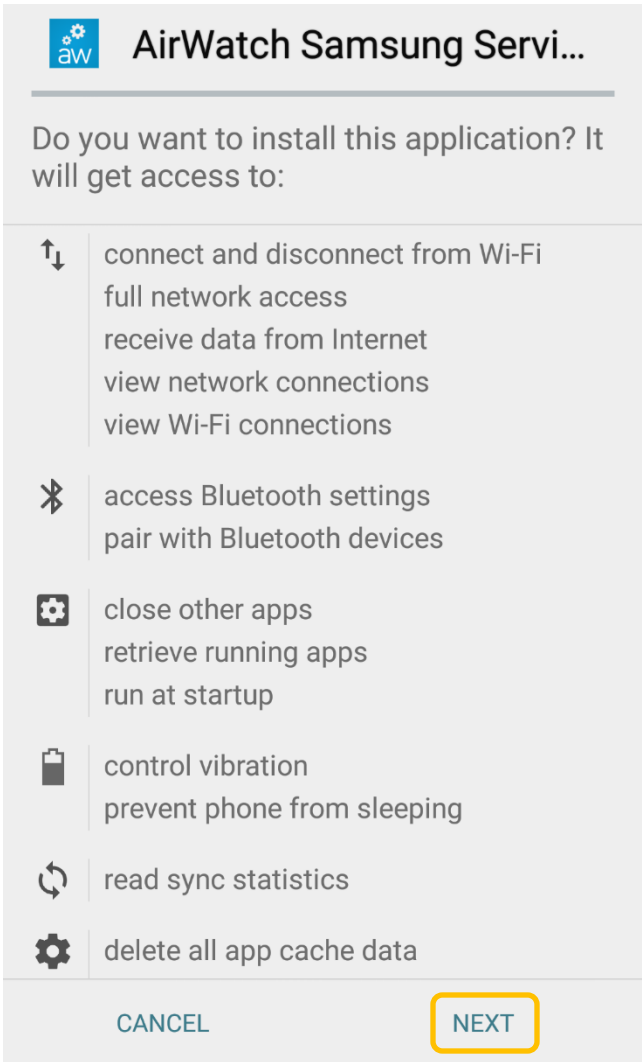

17. Tap on 'Install'

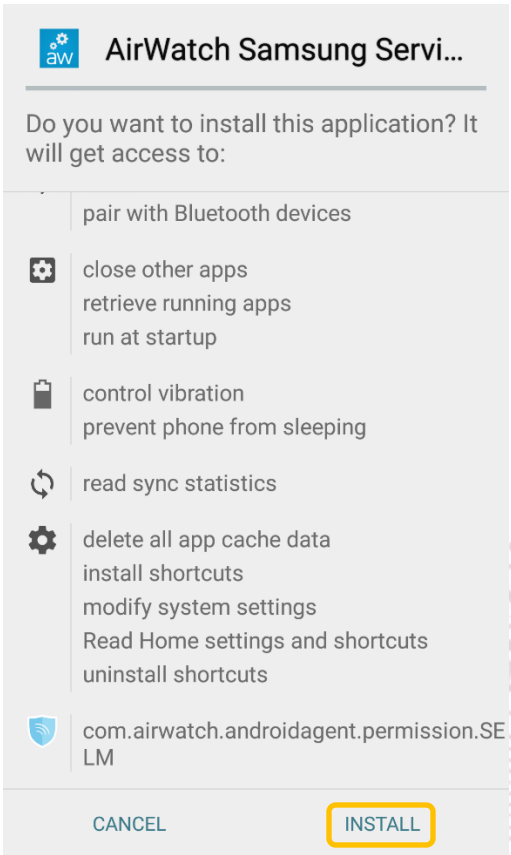

18. Tap on '**Accept**' to allow the installation.

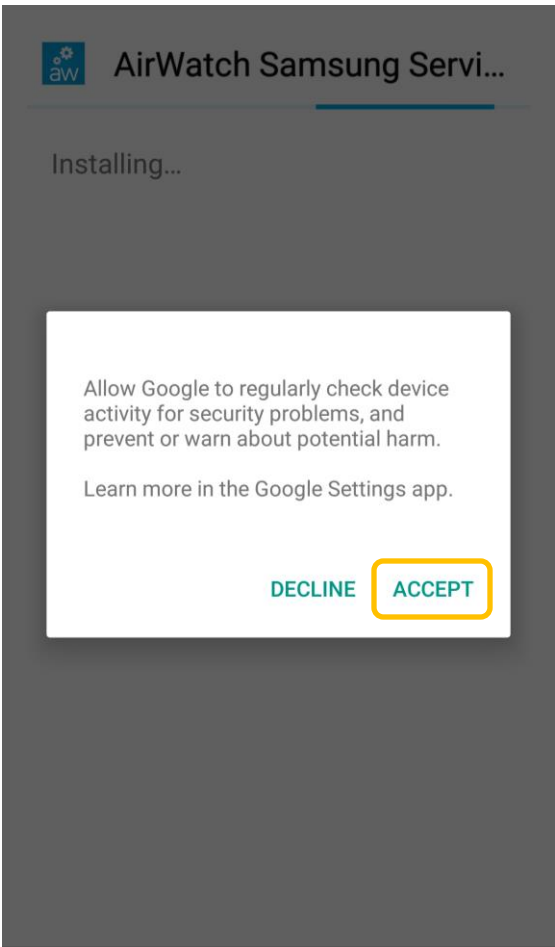

19. Tap on 'Open'

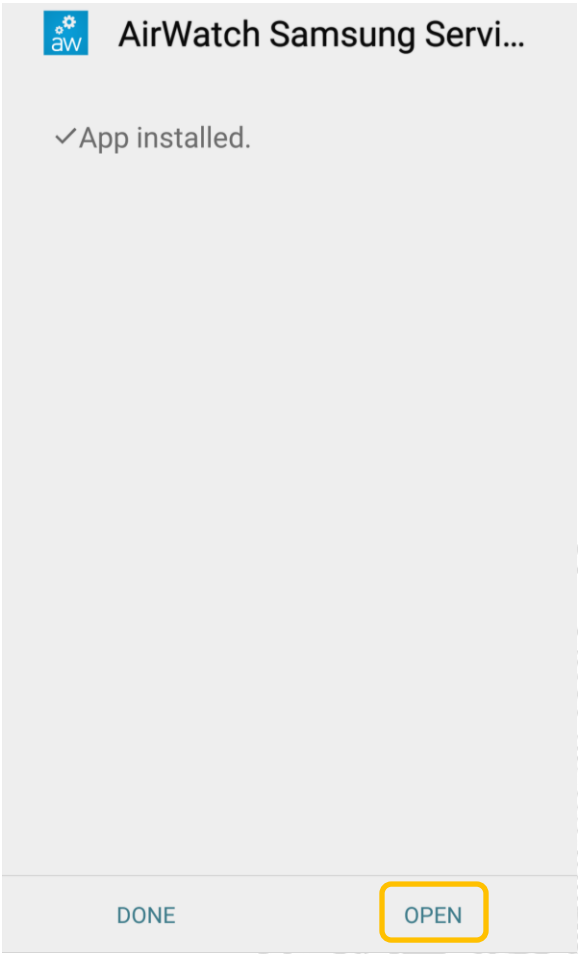

20. Tap on 'Activate'

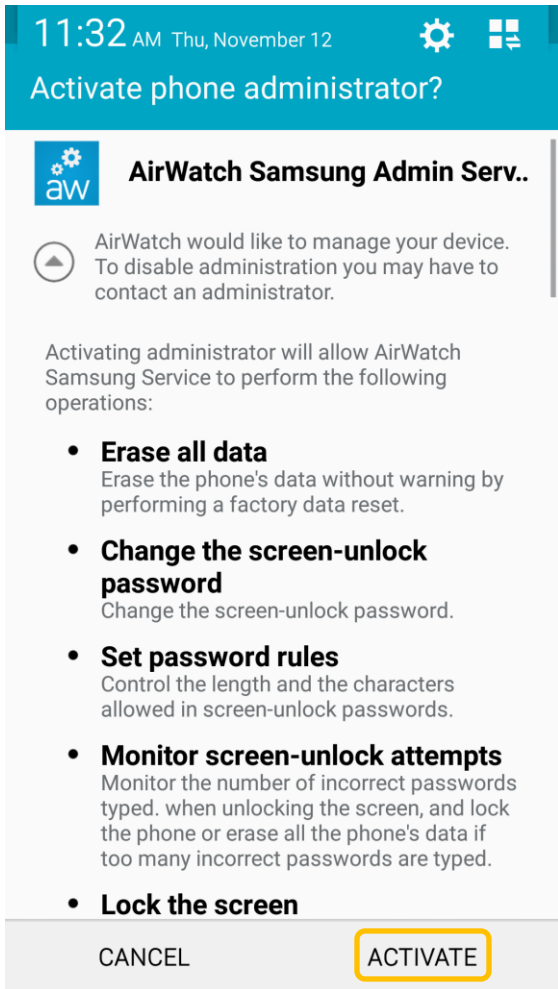

21. Tap on 'Done'

Settings

Select whether to show or hide sensitive notification content on the lock screen.

☒ Show all content

☐ Hide sensitive content

☐ Do not show notifications

DONE

22. Tap on 'Continue'

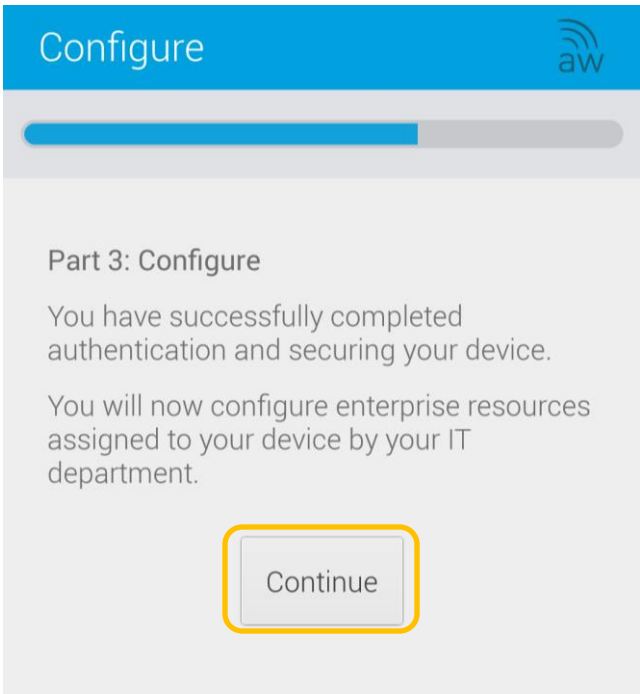

23. Tap on **'Exit'** to complete the installation of AirWatch Agent.

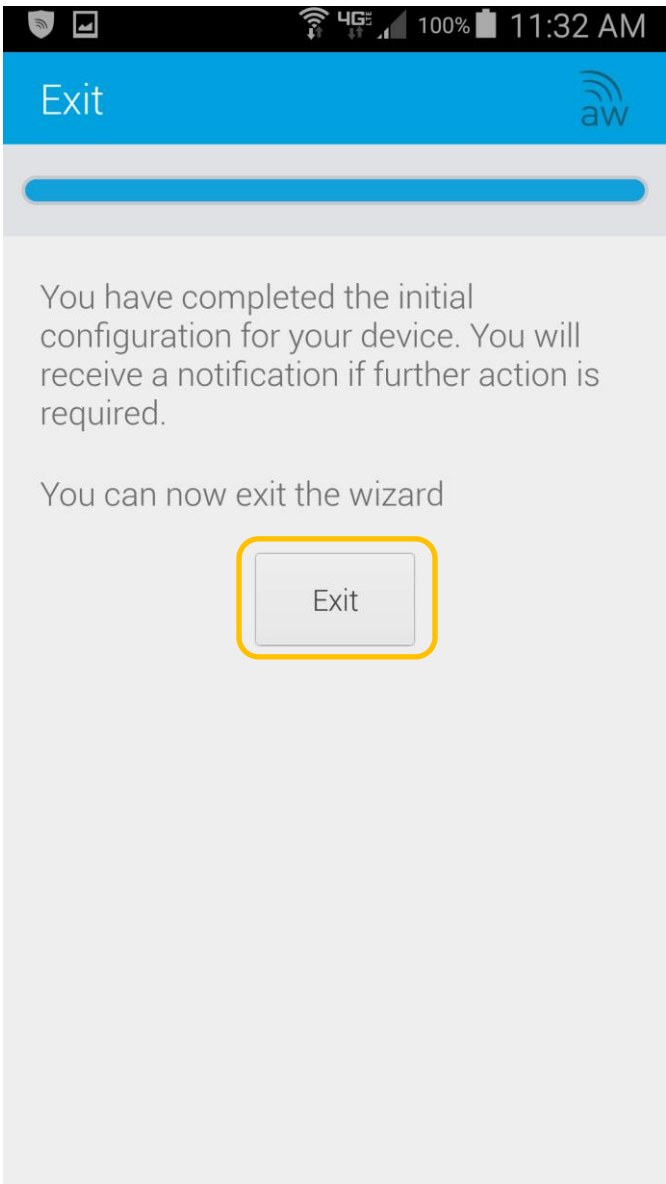

Appendix

Updated : 11/13/2015

